

IT IS A VIOLATION OF LAW FOR ANY PERSON, UNLESS THEY ARE ACTING UNDER THE DIRECTION OF A LICENSED PROFESSIONAL ENGINEER, ARCHITECT, LANDSCAPE ARCHITECT, OR LAND SURVEYOR, TO ALTER AN ITEM IN ANY WAY, IF AN ITEM BEARING THE STAMP OF A LICENSED PROFESSIONAL IS ALTERED. THE ALTERING ENGINEER, ARCHITECT, LANDSCAPE ARCHITECT, OR LAND SURVEYOR SHALL STAMP THE DOCUMENT AND INCLUDE THE NOTATION "ALTERED BY" FOLLOWED BY THEIR SIGNATURE, THE DATE OF SUCH ALTERATION, AND A SPECIFIC DESCRIPTION OF THE ALTERATION.

FILE NAME = I:\29239\CAD\PIN81\BECHTEL\MPT\STAGE-S1 NIGHTS\X73081_CPH_MPP_S1N01-BE.DGN
 DATE/TIME = DGN\$SYTIME\$0223456
 USER = DGN\$USERNAME\$
 DESIGN SUPERVISOR SWS/SAB
 JOB MANAGER RJS
 DESIGN YL/VNC
 CHECK NB
 DRAFTING SLJ/S/SS/VIM
 CHECK YL/NB
 PROJECT MANAGER JR

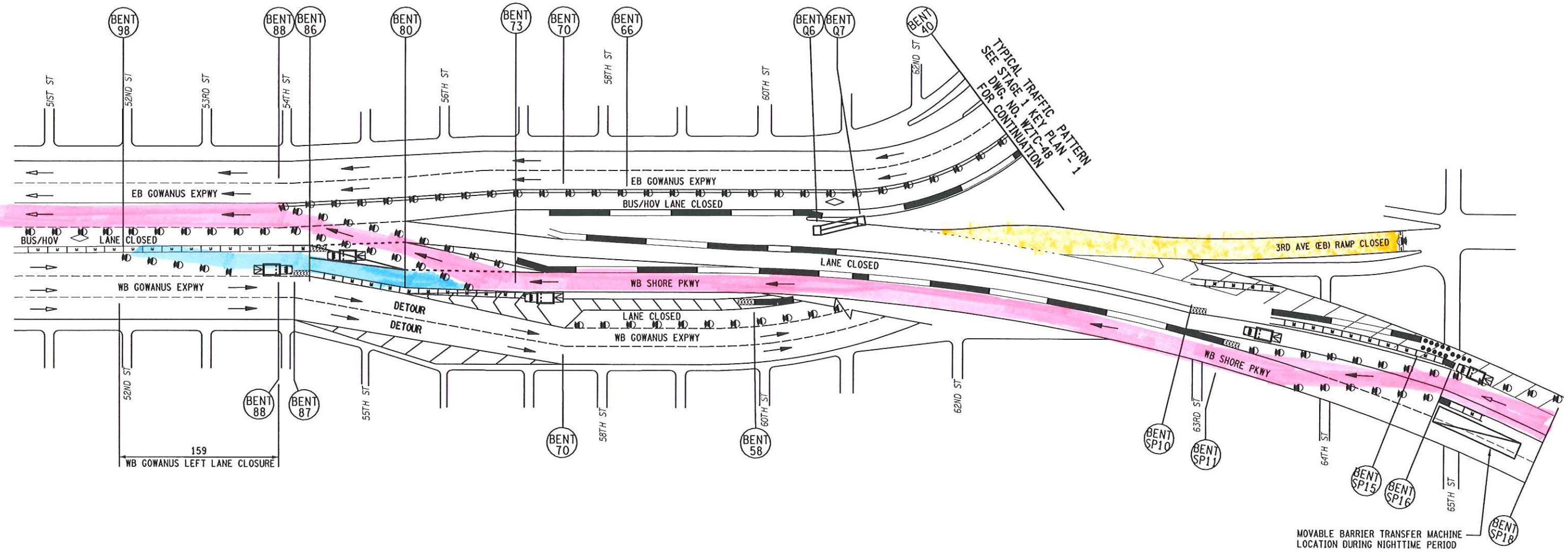
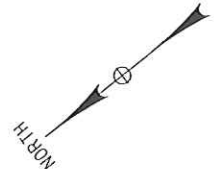

STEEL ERECTION BENT Q6 TO Q7
 STAGE S1 DURING NIGHTTIME PERIOD
 N. T. S.

- = 3rd Avenue on ramp to W/B Shore Parkway
- = Left Lane of W/B Gowanus Expressway to E/B Shore Parkway
- = Lane for W/B Shore Parkway traffic

APPROVED BY:



ALTERED BY:
DATE:

AS-BUILT REVISIONS DESCRIPTION OF ALTERATIONS:	BQE-GOWANUS-PROSPECT EXPRESSWAYS VNB TO RAPELYE ST. \ 4TH AVE. TO CHURCH AVE.	PIN X730.81 PS&E DATE AUG 2009	BRIDGES 1-06531-8	CULVERTS	ALL DIMENSIONS IN m UNLESS OTHERWISE NOTED	CONTRACT NUMBER D261302	BSU Bechtel Sells URSG
	COUNTY: KINGS	DOCUMENT NAME: X73081_CPH_MPP_S1N01-BE.DGN	SHORE PKWY. INTERCHANGE INTERIM DECK REPLACEMENT WORK ZONE TRAFFIC CONTROL		DRAWING NO. WZTC-194 SHEET NO. 285		